

# THE COURTS AT SPRING MILL STATION

## *ELEGANT RIVERFRONT LIVING*

With a premier location alongside the Schuylkill River, a myriad of designer features inside each one of our apartments, and a wide array of deluxe amenities throughout our community, live where luxury, comfort, and style meet to form first-class Conshohocken apartments.

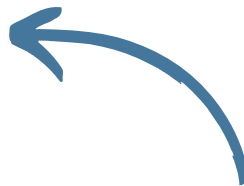

**See for Yourself**





## **DISCOVER ELEVATED LIVING** *In Conshohocken, PA*



**Less than an hour  
from downtown Philly**

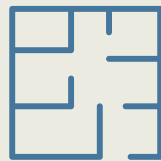

**Variety of one- and  
two-bedroom floor  
plan options**



**Pet friendly**



## *our* **COMMUNITY**



Fully-Equipped  
Fitness Center



Indoor Ball Game  
Courts



Yoga & Pilates  
Studio



High-Definition  
Theater

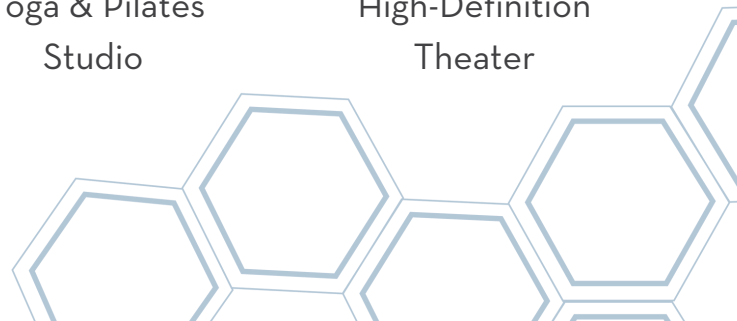



*Everything you need for luxurious living*



Wi-Fi Coffee Cafe  
& Business Center



Resort-Style  
Swimming Pool



Barbecue &  
Picnic Area



Garage  
Parking



Fire  
Pit

# *our* HOMES

Our one-bedroom apartments are ideal for those who value privacy but still want ample space to relax, while our two-bedroom apartments are the top choice for those who enjoy sharing their living space with a close friend.

- Kitchen Island with Breakfast Bar\*
- Stainless-Steel Appliances
- Granite Countertops
- 42" Cabinets In Toffee or Espresso Finish
- Pantry for Added Storage\*
- Glass-Enclosed Shower\*
- Open-Concept Living
- Generous Closet Space
- Schuylkill River Views\*
- Private Patio or Balcony\*
- Custom Window Treatments
- Ceramic Tiling in Kitchen
- Custom Lighting
- Colonial Paneled Interior Doors

\*In select apartment homes





# 1 BEDROOM 1/1.5 BATHROOM

---



766 SF



**\*Den option available**

930 SF



947 SF

1 bed 1.5 bath with den



# 1 BEDROOM 1 BATHROOM LOFT



908 SF  
First floor



908 SF  
Second floor



**\*Den option available**  
930 SF

# 2 BEDROOM 2 BATHROOM

---



1092 SF



**\*Den option available**

1306 SF

# 2 BEDROOM 2 BATHROOM LOFT



1194 SF  
First floor



1194 SF  
Second floor



**\*Den option available**

1419 SF

# EVERYTHING YOU NEED RIGHT WITHIN YOUR *Reach*

- Directly adjacent to the SEPTA Spring Mill Station
- Easy Access to the Schuylkill River Trail
- Steps away from Restaurants and Bars
- Close to Grocery and Retail Shopping
- Easy Commute into Philly, Manyunk or King of Prussia
- Great views of the Schuylkill

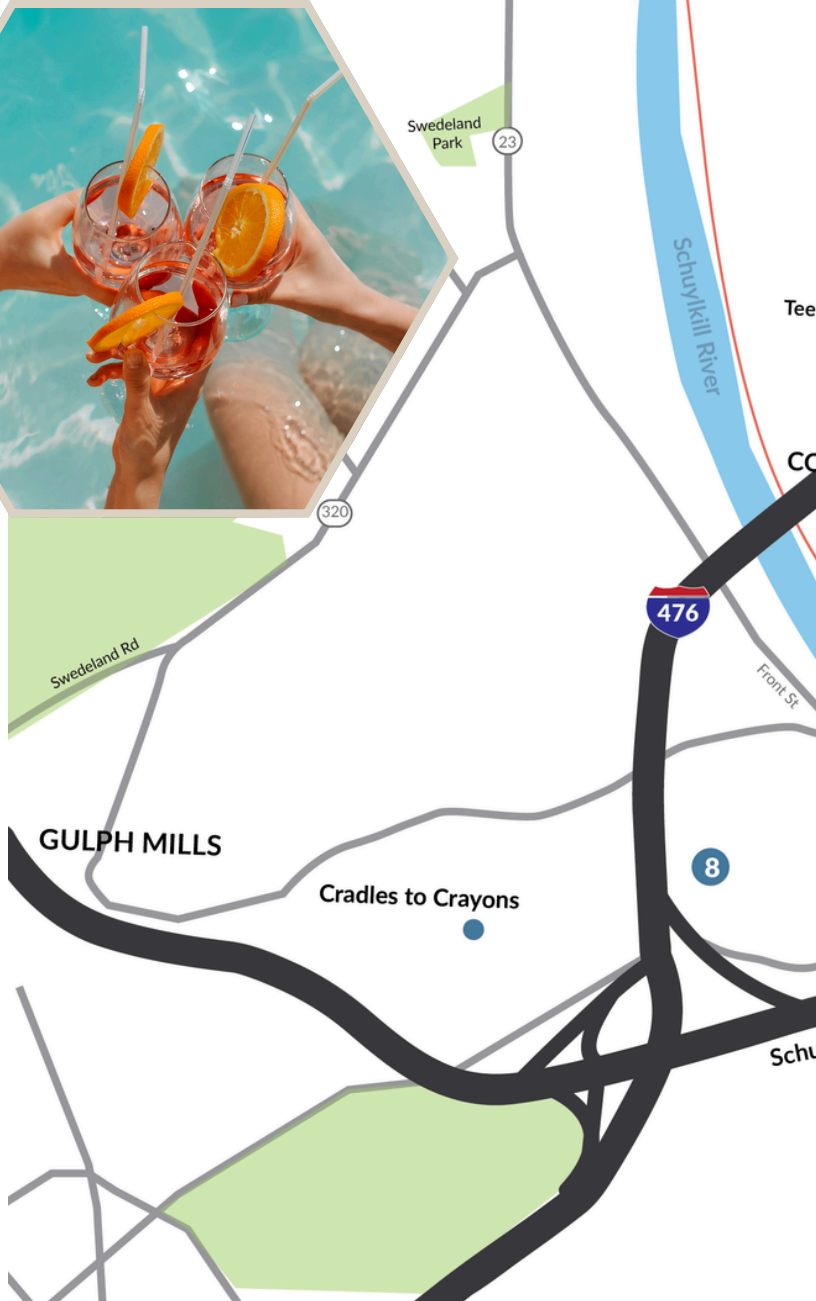

1 BAR LUCCA

2 CONSHY BAKERY

3 TRATTORIA

4 NUDY'S CAFE

5 PEPPERONCINI R

6 FLANIGAN'S BOA

7 CONCHY BREWIN

8 BAR SERA



RESTAURANT  
HOUSE  
NG COMPANY

**FOOD**

- 1 SCHUYLKILL RIVER TRAIL
- 2 PHILADELPHIA COUNTRY CLUB
- 3 CONSHOHOCKEN GARDEN
- 4 SPRING MILL COUNTY PARK
- 5 LEELAND PARK
- 6 GARTWAITE STADIUM
- 7 PLAYGROUND
- 8 MACKENZIE PARK

**THINGS  
TO DO**

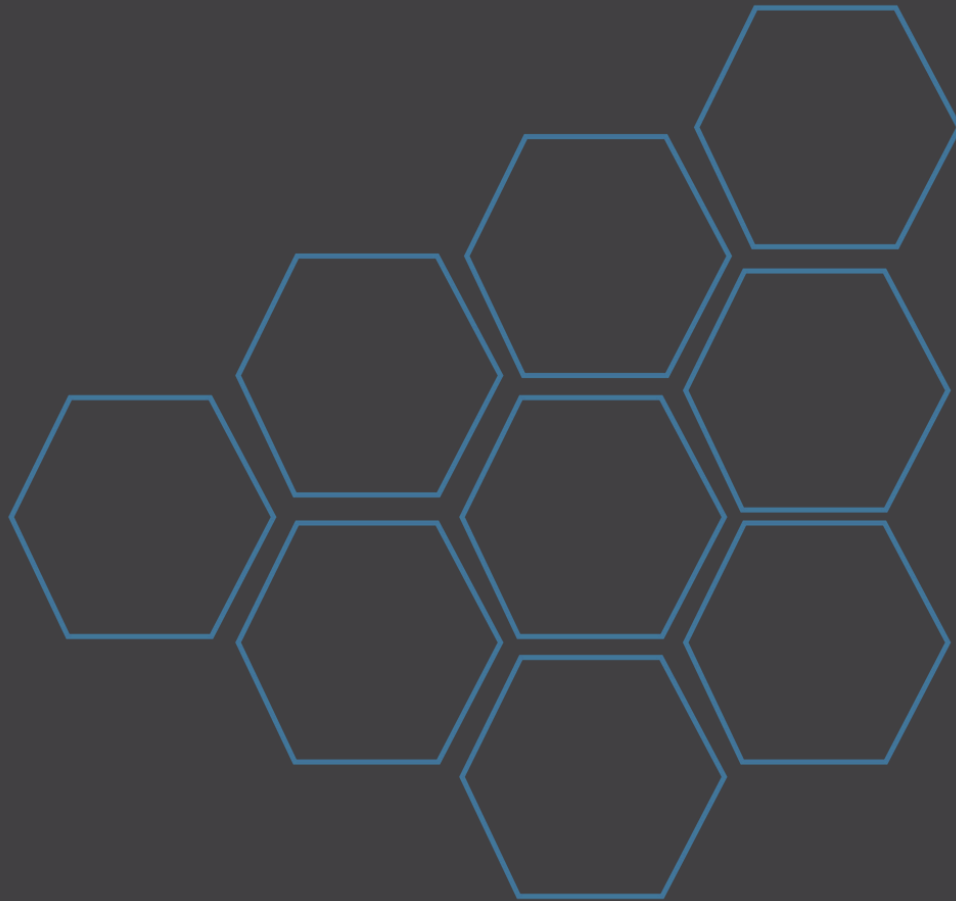

**CourtsatSpringMill.com**

610-825-3523

info@courtsatspringmill.com | @courtsatspringmill